

SHEFFIELD CITY COUNCIL Licensing Sub Committee Report



Report of: Chief Licensing Officer, Head of Licensing

Date: 5th January 2021 at 2pm

Subject: Licensing Act 2003

Author of Report: Clive Stephenson

Summary: To consider an application to grant a premises licence made under the Licensing Act 2003.

Picture House Social 383 Abbeydale Road Sheffield S7 1FS

Recommendations: That Members carefully consider the representations made and take such steps, as the Sub Committee consider necessary for the promotion of the Licensing Objectives.

Background Papers: Attached documents

Category of Report: OPEN

**REPORT OF THE CHIEF LICENSING OFFICER
(HEAD OF LICENSING) TO THE LICENSING SUB COMMITTEE
LICENSING ACT 2003**

Ref No 01/21

Picture House Social 383 Abbeydale Road Sheffield S7 1FS

1.0 PURPOSE OF REPORT

- 1.1 To consider an application for the grant of a premises licence made under section 17 of the Licensing Act 2003.

2.0 THE APPLICATION

- 2.1 The applicant is Bar Public Limited
- 2.2 The application was received by the Licensing Service on the 11th November 2020 which is attached to Appendix A of this report.

3.0 REASONS FOR REFERRAL

- 3.1 Representations concerning the application have been received from the following:-
- 1 x interested party
- 3.2 The applicant and objectors who made written representations have been invited to attend the hearing. Copies of the front page of the notices are attached to this report labelled Appendix 'C'.

4.0 POLICIES TO CONSIDER

- 4.1 Sheffield City Council Statement of Licensing Policy.

<https://www.sheffield.gov.uk/home/business/licences-permits-registrations/about-licences>

5.0 FINANCIAL IMPLICATIONS

- 5.1 There are no specific financial implications arising from this application. However, additional costs may be incurred should the matter go to appeal. In such an eventuality it may not be possible to recover all these costs. The impact of these additional costs (if any) will be kept under review and may be subject of a further report during the year.

6.0 THE LEGAL POSITION

- 6.1 The Licensing Act 2003 at section 4 (1) requires the Licensing Authority to carry out its functions with a view to promoting the Licensing Objectives which section 4(2) sets out as:-
- a) the prevention of crime and disorder,
 - b) public safety,
 - c) the prevention of public nuisance,
 - d) the protection of children from harm.

- 6.2 Section 4(3) of the Licensing Act also requires the Licensing Authority to have regard to the published statement of Licensing Policy and any guidance issued by the Secretary of State under section 182.

7.0 HEARINGS REGULATIONS

- 7.1 Regulations governing hearings under the Licensing Act 2003 have been made by the Secretary of State.
- 7.2 The Licensing Authority has provided all parties with the information required in the Regulations to the 2003 Act as set out at Appendix 'C'.
- 7.3 Attached at Appendix 'C' is the following: -
- a) a copy of the Notice of Hearing;
 - b) the rights of a party provided in Regulations 15 and 16;
 - c) the consequences if a party does not attend or is not represented at the hearing
 - d) the procedure to be followed at the hearing.

8.0 APPEALS

- 8.1 The Licensing Act 2003 section 181 and Schedule 5 makes provision for appeals to be made by the applicant and those making representations against decisions of the Licensing Authority to the Magistrates' Court.

9.0 RECOMMENDATIONS

- 9.1 That Members carefully consider the representations made and take such steps as the Sub Committee consider appropriate for the promotion of the Licensing Objectives.

10.0 OPTIONS OPEN TO THE COMMITTEE

- 10.1 To grant the premises licence in the terms requested.
- 10.2 To grant the premises licence with conditions.
- 10.3 To reject the whole or part of the application.



Stephen Lonnia
Chief Licensing Officer, Head of Licensing

Date: 17th December 2020

Appendix 'A'

Application

Application for a premises licence to be granted under the Licensing Act 2003

PLEASE READ THE FOLLOWING INSTRUCTIONS FIRST

Before completing this form please read the guidance notes at the end of the form. If you are completing this form by hand please write legibly in block capitals. In all cases ensure that your answers are inside the boxes and written in black ink. Use additional sheets if necessary.

You may wish to keep a copy of the completed form for your records.

I/we BAR PUBLIC LIMITED
(Insert name(s) of applicant)

apply for a premises licence under section 17 of the Licensing Act 2003 for the premises described in Part 1 below (the premises) and I/we are making this application to you as the relevant licensing authority in accordance with section 12 of the Licensing Act 2003

Part 1 – Premises details

Postal address of premises or, if none, Ordnance Survey map reference or description <u>PICTURE HOUSE SOCIAL</u> <u>383 ABBEYDALE ROAD</u>			
Post town	<u>SHEFFIELD</u>	Postcode	<u>S7 1FS</u>
Telephone number at premises (if any)			
Non-domestic rateable value of premises		£ <u>17,250</u>	

Part 2 – Applicant details

Please state whether you are applying for a premises licence as

Please tick as appropriate

- | | | |
|--|-------------------------------------|-----------------------------|
| a) an individual or individuals * | <input type="checkbox"/> | please complete section (A) |
| b) a person other than an individual * | <input checked="" type="checkbox"/> | please complete section (A) |
| i as a limited company/limited liability partnership | <input type="checkbox"/> | please complete section (B) |
| ii as a partnership (other than limited liability) | <input type="checkbox"/> | please complete section (B) |
| iii as an unincorporated association or | <input type="checkbox"/> | please complete section (B) |
| iv other (for example a statutory corporation) | <input type="checkbox"/> | please complete section (B) |
| c) a recognised club | <input type="checkbox"/> | please complete section (B) |
| d) a charity | <input type="checkbox"/> | please complete section (B) |
| e) the proprietor of an educational establishment | <input type="checkbox"/> | please complete section (B) |
| f) a health service body | <input type="checkbox"/> | please complete section (B) |
| g) a person who is registered under Part 2 of the Care Standards Act 2000 (c14) in respect of an independent hospital in Wales | <input type="checkbox"/> | please complete section (B) |
| g(a) a person who is registered under Chapter 2 of Part 1 of the Health and Social Care Act 2008 (within the meaning of that Part) in an independent hospital in England | <input type="checkbox"/> | please complete section (B) |
| h) the chief officer of police of a police force in England and Wales | <input type="checkbox"/> | please complete section (B) |

* If you are applying as a person described in (a) or (b) please confirm (by ticking yes to one box below)

- I am carrying on or proposing to carry on a business which involves the use of the premises for licensable activities; or ☒
- I am making the application pursuant to a
- statutory function or ☐
- a function discharged by virtue of Her Majesty's prerogative ☐

(A) INDIVIDUAL APPLICANTS (fill in as applicable)

Mr <input type="checkbox"/>	Mrs <input type="checkbox"/>	Miss <input type="checkbox"/>	Ms <input type="checkbox"/>	Other Title (for example, Rev)	
Surname			First names		
Date of birth			I am 18 years old or over <input type="checkbox"/> Please tick yes		
Nationality					
Current residential address if different from premises address					
Post town				Postcode	
Daytime contact telephone number					
E-mail address (optional)					

SECOND INDIVIDUAL APPLICANT (if applicable)

Mr <input type="checkbox"/>	Mrs <input type="checkbox"/>	Miss <input type="checkbox"/>	Ms <input type="checkbox"/>	Other Title (for example, Rev)	
Surname			First names		
Date of birth			I am 18 years old or over <input type="checkbox"/> Please tick yes		
Nationality					
Current postal address if different from premises address					
Post town				Postcode	
Daytime contact telephone number					
E-mail address (optional)					

(B) OTHER APPLICANTS

Please provide name and registered address of applicant in full. Where appropriate please give any registered number. In the case of a partnership or other joint venture (other than a body corporate), please give the name and address of each party concerned.

Name	BAR PUBLIC LIMITED
Address	OSBORN WORKS, UNIT 4A, RUTLAND WAY, SHEFFIELD S3 8DQ
Registered number (where applicable)	10565331
Description of applicant (for example, partnership, company, unincorporated association etc.)	LIMITED COMPANY
Telephone number (if any)	
E-mail address (optional)	

Part 3 Operating Schedule

When do you want the premises licence to start?

DD MM YYYY
11 11 2020

If you wish the licence to be valid only for a limited period, when do you want it to end?

DD MM YYYY

Please give a general description of the premises (please read guidance note 1)

PICTURE HOUSE SOCIAL IS A BAR SITUATED IN THE BASEMENT
OF ABBEYDALE PICTURE HOUSE AT 383 ABBEYDALE ROAD
- WE ARE THE EXISTING LICENCE HOLDER BUT ARE APPLYING
FOR THIS LICENCE TO REPLACE THE ONE HELD BY OUR
PREVIOUS COMPANY - PH SOCIAL ENTERTAINMENT LTD

If 5,000 or more people are expected to attend the premises at any one time,
please state the number expected to attend.

What licensable activities do you intend to carry on from the premises?

(please see sections 1 and 14 and Schedules 1 and 2 to the Licensing Act 2003)

Provision of regulated entertainment (please read guidance note 2)

Please tick all that apply

- | | |
|--|-------------------------------------|
| a) plays (if ticking yes, fill in box A) | <input type="checkbox"/> |
| b) films (if ticking yes, fill in box B) | <input checked="" type="checkbox"/> |
| c) indoor sporting events (if ticking yes, fill in box C) | <input checked="" type="checkbox"/> |
| d) boxing or wrestling entertainment (if ticking yes, fill in box D) | <input type="checkbox"/> |
| e) live music (if ticking yes, fill in box E) | <input checked="" type="checkbox"/> |
| f) recorded music (if ticking yes, fill in box F) | <input checked="" type="checkbox"/> |
| g) performances of dance (if ticking yes, fill in box G) | <input type="checkbox"/> |
| h) anything of a similar description to that falling within (a), (f) or (g)
(if ticking yes, fill in box H) | <input type="checkbox"/> |

Provision of late night refreshment (if ticking yes, fill in box I)

☒

Supply of alcohol (if ticking yes, fill in box J)

☒

In all cases complete boxes K, L and M

A

Plays Standard days and timings (please read guidance note 7)			Will the performance of a play take place indoors or outdoors or both – please tick (please read guidance note 3)	Indoors	<input type="checkbox"/>
				Outdoors	<input type="checkbox"/>
				Both	<input type="checkbox"/>
Day	Start	Finish	Please give further details here (please read guidance note 4)		
Mon					
Tue					
Wed					
Thur			State any seasonal variations for performing plays (please read guidance note 5)		
Fri					
Sat			Non standard timings. Where you intend to use the premises for the performance of plays at different times to those listed in the column on the left, please list (please read guidance note 6)		
Sun					

B

Films Standard days and timings (please read guidance note 7)			Will the exhibition of films take place indoors or outdoors or both – please tick (please read guidance note 3)	Indoors	<input checked="" type="checkbox"/>
				Outdoors	<input type="checkbox"/>
				Both	<input type="checkbox"/>
Day	Start	Finish	Please give further details here (please read guidance note 4) WE HAVE A SMALL 24 SEAT CINEMA WITHIN THE BAR THAT OCCASIONALLY SCREENS FILMS		
Mon	12.00	00.30			
Tue	12.00	00.30			
Wed	12.00	00.30			
Thur	12.00	00.30	State any seasonal variations for the exhibition of films (please read guidance note 5)		
Fri	12.00	03.00			
Sat	12.00	03.00	Non standard timings. Where you intend to use the premises for the exhibition of films at different times to those listed in the column on the left, please list (please read guidance note 6)		
Sun	12.00	00.30			

C

Indoor sporting events Standard days and timings (please read guidance note 7)			Please give further details (please read guidance note 4) WE HAVE PING PONG TABLES AND DECK SHUFFLE BOARD WITHIN THE BAR
Day	Start	Finish	
Mon	12.00	00.30	State any seasonal variations for indoor sporting events (please read guidance note 5)
Tue	12.00	00.30	
Wed	12.00	00.30	
Thur	12.00	00.30	Non standard timings. Where you intend to use the premises for indoor sporting events at different times to those listed in the column on the left, please list (please read guidance note 6)
Fri	12.00	03.00	
Sat	12.00	03.00	
Sun	12.00	00.30	

D

Boxing or wrestling entertainments Standard days and timings (please read guidance note 7)			Will the boxing or wrestling entertainment take place indoors or outdoors or both – please tick (please read guidance note 3)	Indoors	<input type="checkbox"/>
Day	Start	Finish		Outdoors	<input type="checkbox"/>
Mon			Please give further details here (please read guidance note 4)	Both	<input type="checkbox"/>
Tue					
Wed					
Thur			State any seasonal variations for boxing or wrestling entertainment (please read guidance note 5)		
Fri					
Sat			Non standard timings. Where you intend to use the premises for boxing or wrestling entertainment at different times to those listed in the column on the left, please list (please read guidance note 6)		
Sun					

E

Live music Standard days and timings (please read guidance note 7)			<u>Will the performance of live music take place indoors or outdoors or both – please tick</u> (please read guidance note 3) Indoors <input checked="" type="checkbox"/> Outdoors <input type="checkbox"/> Both <input type="checkbox"/>
Day	Start	Finish	
Mon	12.00	00.30	
Tue	12.00	00.30	<u>Please give further details here</u> (please read guidance note 4) WE MAY OCCASIONALLY HAVE LIVE MUSIC PERFORMANCES IN THE BAR + THE GAME ROOM AREAS
Wed	12.00	00.30	
Thur	12.00	00.30	<u>State any seasonal variations for the performance of live music</u> (please read guidance note 5) —
Fri	12.00	03.00	
Sat	12.00	03.00	<u>Non standard timings. Where you intend to use the premises for the performance of live music at different times to those listed in the column on the left, please list</u> (please read guidance note 6) —
Sun	12.00	00.30	

F

Recorded music Standard days and timings (please read guidance note 7)			<u>Will the playing of recorded music take place indoors or outdoors or both – please tick</u> (please read guidance note 3) Indoors <input checked="" type="checkbox"/> Outdoors <input type="checkbox"/> Both <input type="checkbox"/>
Day	Start	Finish	
Mon	12.00	00.30	
Tue	12.00	00.30	<u>Please give further details here</u> (please read guidance note 4) WE HAVE DJ'S ON WEEKENDS AND PLAYLISTS OF RECORDED MUSIC DURING ALL OPENING HOURS
Wed	12.00	00.30	
Thur	12.00	00.30	<u>State any seasonal variations for the playing of recorded music</u> (please read guidance note 5) —
Fri	12.00	03.00	
Sat	12.00	03.00	<u>Non standard timings. Where you intend to use the premises for the playing of recorded music at different times to those listed in the column on the left, please list</u> (please read guidance note 6) —
Sun	12.00	00.30	

Sections G & F are blank on the original form, so are not included in this copy for the report.

Late night refreshment Standard days and timings (please read guidance note 7)			Will the provision of late night refreshment take place indoors or outdoors or both – please tick (please read guidance note 3)	Indoors	<input type="checkbox"/>
				Outdoors	<input type="checkbox"/>
Day	Start	Finish		Both	<input checked="" type="checkbox"/>
Mon	12.00	00.30	Please give further details here (please read guidance note 4) WE HAVE AN ON SITE PIZZA FALLOU THAT SUPPLIES FOODS TO CUSTOMERS BOTH ON SITE AND FOR TAKEAWAY		
Tue	12.00	00.30			
Wed	12.00	00.30	State any seasonal variations for the provision of late night refreshment (please read guidance note 5)		
Thur	12.00	00.30			
Fri	12.00	03.00	Non standard timings. Where you intend to use the premises for the provision of late night refreshment at different times, to those listed in the column on the left, please list (please read guidance note 6)		
Sat	12.00	03.00			
Sun	12.00	00.30			

J

Supply of alcohol Standard days and timings (please read guidance note 7)			Will the supply of alcohol be for consumption – please tick (please read guidance note 8)	On the premises	<input type="checkbox"/>
				Off the premises	<input type="checkbox"/>
Day	Start	Finish		Both	<input checked="" type="checkbox"/>
Mon	12.00	00.30	State any seasonal variations for the supply of alcohol (please read guidance note 5)		
Tue	12.00	00.30			
Wed	12.00	00.30			
Thur	12.00	00.30	Non standard timings. Where you intend to use the premises for the supply of alcohol at different times to those listed in the column on the left, please list (please read guidance note 6)		
Fri	12.00	03.00			
Sat	12.00	03.00			
Sun	12.00	00.30			

State the name and details of the individual whom you wish to specify on the licence as designated premises supervisor (Please see declaration about the entitlement to work in the checklist at the end of the form):

Name	JOHN WESTHEAD
Date of birth	[REDACTED]
Address	[REDACTED]
Postcode	[REDACTED]
Personal licence number (if known)	SY 07185 PER
Issuing licensing authority (if known)	SHEFFIELD CITY COUNCIL

K

Please highlight any adult entertainment or services, activities, other entertainment or matters ancillary to the use of the premises that may give rise to concern in respect of children (please read guidance note 9).

--

L

Hours premises are open to the public Standard days and timings (please read guidance note 7)			State any seasonal variations (please read guidance note 5)
Day	Start	Finish	Non standard timings. Where you intend the premises to be open to the public at different times from those listed in the column on the left, please list (please read guidance note 6)
Mon	16.00	00.30	
Tue	16.00	00.30	
Wed	16.00	00.30	
Thur	16.00	00.30	
Fri	16.00	03.00	
Sat	12.00	03.00	
Sun	12.00	00.30	

M Describe the steps you intend to take to promote the four licensing objectives:

a) General – all four licensing objectives (b, c, d and e) (please read guidance note 10)

- CCTV IN OPERATION ACROSS THE SITE
- CHALLENGE 21
- QUALIFIED DOOR TEAM ON WEEKENDS
- FIRST AIDERS ACROSS OUR TEAM
- RISK ASSESSMENTS + FIRE REGS REGULARLY UPDATED

b) The prevention of crime and disorder

- CCTV IS IN OPERATION
- QUALIFIED DOOR TEAM

c) Public safety

- CCTV
- QUALIFIED DOOR TEAM
- RISK ASSESSMENTS REGULARLY UPDATED
- FIRST AIDERS ON SITE
- CHALLENGE 21

d) The prevention of public nuisance

- DOORMAN ON SITE
- SIGNAGE UPON EXIT
- CHALLENGE 21

e) The protection of children from harm

- CHALLENGE 21
- QUALIFIED DOORMAN

Checklist:

Please tick to indicate agreement

- I have made or enclosed payment of the fee. ☒
- I have enclosed the plan of the premises. ☒
- I have sent copies of this application and the plan to responsible authorities and others where applicable. ☒
- I have enclosed the consent form completed by the individual I wish to be designated premises supervisor, if applicable. ☒
- I understand that I must now advertise my application. ☒
- I understand that if I do not comply with the above requirements my application will be rejected. ☒
- [Applicable to all individual applicants, including those in a partnership which is not a limited liability partnership, but not companies or limited liability partnerships] I have included documents demonstrating my entitlement to work in the United Kingdom (please read note 15). ☐

IT IS AN OFFENCE, UNDER SECTION 158 OF THE LICENSING ACT 2003, TO MAKE A FALSE STATEMENT IN OR IN CONNECTION WITH THIS APPLICATION. THOSE WHO MAKE A FALSE STATEMENT MAY BE LIABLE ON SUMMARY CONVICTION TO A FINE OF ANY AMOUNT.

IT IS AN OFFENCE UNDER SECTION 24B OF THE IMMIGRATION ACT 1971 FOR A PERSON TO WORK WHEN THEY KNOW, OR HAVE REASONABLE CAUSE TO BELIEVE, THAT THEY ARE DISQUALIFIED FROM DOING SO BY REASON OF THEIR IMMIGRATION STATUS. THOSE WHO EMPLOY AN ADULT WITHOUT LEAVE OR WHO IS SUBJECT TO CONDITIONS AS TO EMPLOYMENT WILL BE LIABLE TO A CIVIL PENALTY UNDER SECTION 15 OF THE IMMIGRATION, ASYLUM AND NATIONALITY ACT 2006 AND PURSUANT TO SECTION 21 OF THE SAME ACT, WILL BE COMMITTING AN OFFENCE WHERE THEY DO SO IN THE KNOWLEDGE, OR WITH REASONABLE CAUSE TO BELIEVE, THAT THE EMPLOYEE IS DISQUALIFIED.

Part 4 – Signatures (please read guidance note 11)



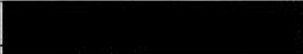

Signature of applicant or applicant's solicitor or other duly authorised agent (see guidance note 12). If signing on behalf of the applicant, please state in what capacity.

Declaration	<ul style="list-style-type: none">• [Applicable to individual applicants only, including those in a partnership which is not a limited liability partnership] I understand I am not entitled to be issued with a licence if I do not have the entitlement to live and work in the UK (or if I am subject to a condition preventing me from doing work relating to the carrying on of a licensable activity) and that my licence will become invalid if I cease to be entitled to live and work in the UK (please read guidance note 15).• The DPS named in this application form is entitled to work in the UK (and is not subject to conditions preventing him or her from doing work relating to a licensable activity) and I have seen a copy of his or her proof of entitlement to work, if appropriate (please see note 15).
Signature	
Date	11/11/20
Capacity	DIRECTOR OF BAR PUBUK LIMITED

For joint applications, signature of 2nd applicant or 2nd applicant's solicitor or other authorised agent (please read guidance note 15). If signing on behalf of the applicant, please state in what capacity.

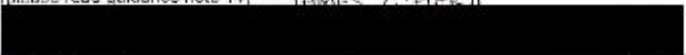
Signature	
Date	
Capacity	

Contact name (where not previously given) and postal address for correspondence associated with this application (please read guidance note 14). **TRAVEL CLUB**

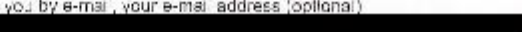
	
Post town	
Postcode	
Telephone number (if any) 	
If you would prefer us to correspond with you by e-mail, your e-mail address (optional) 	

Notes for Guidance

1. Describe the premises, for example the type of premises, its general situation and layout and any other information which could be relevant to the licensing objectives. Where your application includes off-supplies of alcohol and you intend to provide a place for consumption of these off-supplies, you must include a description of where the place will be and its proximity to the premises.
2. In terms of specific regulated entertainments please note that:
 - **Plays:** no licence is required for performances between 08.00 and 23.00 on any day, provided that the audience does not exceed 500.
 - **Films:** no licence is required for not-for-profit film exhibition held in community premises between 06.00 and 23.00 on any day provided that the audience does not exceed 500 and the organiser (a) gets consent to the screening from a person who is responsible for the premises; and (b) ensures that each such screening abides by age classification ratings.
 - **Indoor sporting events:** no licence is required for performances between 06.00 and 23.00 on any day, provided that the audience does not exceed 1000.
 - **Boxing or Wrestling Entertainment:** no licence is required for a contest, exhibition or display of Greco-Roman wrestling, or freestyle wrestling between 06.00 and 23.00 on any day, provided that the audience does not exceed 1000. Combined fighting events – defined as a contest, exhibition or display which combines boxing or wrestling with one or more martial arts – are licensable as a boxing or wrestling entertainment rather than an indoor sporting event.
 - **Live music:** no licence permission is required for:
 - a performance of unamplified live music between 08.00 and 23.00 on any day, on any premises;
 - a performance of amplified live music between 08.00 and 23.00 on any day on premises authorised to sell alcohol for consumption on those premises, provided that the audience does not exceed 500;
 - a performance of amplified live music between 08.00 and 23.00 on any day, in a workplace that is not licensed to sell alcohol on those premises, provided that the audience does not exceed 500;
 - a performance of amplified live music between 08.00 and 23.00 on any day, in a church hall, village hall, community hall, or other similar community premises, that is not licensed by a premises licence to sell alcohol, provided that (a) the audience does not exceed 500, and (b) the organiser gets consent for the performance from a person who is responsible for the premises;
 - a performance of amplified live music between 08.00 and 23.00 on any day, at the non-residential premises of (i) a local authority, or (ii) a school, or (iii) a hospital, provided that (a) the audience does not exceed 500, and (b) the organiser gets consent for the performance on the relevant premises from: (i) the local authority concerned, or (ii) the school or (iii) the health care provider for the hospital.
 - **Recorded Music:** no licence permission is required for:
 - any playing of recorded music between 08.00 and 23.00 on any day on premises authorised to sell alcohol for consumption on those premises, provided that the audience does not exceed 500;
 - any playing of recorded music between 08.00 and 23.00 on any day, in a church hall, village hall, community hall, or other similar community premises, that is not licensed by a premises licence to sell alcohol, provided that (a) the audience does not exceed 500, and (b) the organiser gets consent for the performance from a person who is responsible for the premises;
 - any playing of recorded music between 08.00 and 23.00 on any day, at the non-residential premises of (i) a local authority, or (ii) a school, or (iii) a hospital, provided that (a) the audience does not exceed 500, and (b) the organiser gets consent for the performance on the relevant premises from: (i) the local authority concerned, or (ii) the school proprietor or (iii) the health care provider for the hospital.
 - **Dance:** no licence is required for performances between 06.00 and 23.00 on any day, provided that the audience does not exceed 500. However, a performance which amounts to adult entertainment remains licensable.
 - **Cross activity exemptions:** no licence is required between 06.00 and 23.00 on any day, with no limit on audience size for:
 - any entertainment taking place on the premises of the local authority where the entertainment is provided by or on behalf of the local authority;
 - any entertainment taking place on the hospital premises of the health care provider where the entertainment is provided by or on behalf of the health care provider;
 - any entertainment taking place on the premises of the school where the entertainment is provided by or on behalf of the school proprietor; and
 - any entertainment (excluding films and a boxing or wrestling entertainment) taking place at a travelling circus, provided that (a) it takes place within a moveable structure that accommodates the audience, and (b) that the travelling circus has not been located on the same site for more than 28 consecutive days.
3. Where taking place in a building or other structure please tick as appropriate (Indoors may include a tent).
4. For example the type of activity to be authorised, if not already stated, and give relevant further details, for example (but not exclusively) whether or not music will be amplified or unamplified.
5. For example (but not exclusively), where the activity will occur on additional days during the summer months.

6. For example (but not exclusively), where you wish the activity to go on longer on a particular day e.g. Christmas Eve.
7. Please give timings in 24 hour clock (e.g. 16.00) and only give details for the days of the week when you intend the premises to be used for the activity.
8. If you wish people to be able to consume alcohol on the premises, please tick 'on the premises'. If you wish people to be able to purchase alcohol to consume away from the premises, please tick 'off the premises'. If you wish people to be able to do both, please tick 'both'.
9. Please give information about anything intended to occur at the premises or ancillary to the use of the premises which may give rise to concern in respect of children, regardless of whether you intend children to have access to the premises, for example (but not exclusively); nudity or semi-nudity, films for restricted age groups or the presence of gaming machines.
10. Please list here steps you will take to promote all four licensing objectives together.
11. The application form must be signed.
12. An applicant's agent (for example solicitor) may sign the form on their behalf provided that they have actual authority to do so.
13. Where there is more than one applicant, each of the applicants or their respective agent must sign the application form.
14. This is the address which we shall use to correspond with you about this application.

15. Entitlement to work/immigration status for individual applicants and applications from partnerships which are not limited liability partnerships:

A licence may not be held by an individual or an individual in a partnership who is resident in the UK who:

- does not have the right to live and work in the UK; or
- is subject to a condition preventing him or her from doing work relating to the carrying on of a licensable activity.

Any premises licence issued in respect of an application made on or after 8 April 2017 will become invalid if the holder ceases to be entitled to work in the UK.

Applicants must demonstrate that they have an entitlement to work in the UK and are not subject to a condition preventing them from doing work relating to the carrying on of a licensable activity. They do this by providing with this application copies or scanned copies of the following documents (which do not need to be certified).

Documents which demonstrate entitlement to work in the UK

- An expired or current passport showing the holder, or a person named in the passport as the child of the holder, is a British citizen or a citizen of the UK and Colonies having the right of abode in the UK (please see note below about which sections of the passport to copy).
- An expired or current passport or national identity card showing the holder, or a person named in the passport as the child of the holder, is a national of a European Economic Area country or Switzerland.
- A Registration Certificate or document certifying permanent residence issued by the Home Office to a national of a European Economic Area country or Switzerland.
- A Permanent Residence Card issued by the Home Office to the family member of a national of a European Economic Area country or Switzerland.
- A current Biometric Immigration Document (Biometric Residence Permit) issued by the Home Office to the holder indicating that the person named is allowed to stay indefinitely in the UK, or has no time limit on their stay in the UK.
- A current passport endorsed to show that the holder is exempt from immigration control, is allowed to stay indefinitely in the UK, has the right of abode in the UK, or has no time limit on their stay in the UK.
- A current Immigration Status Document issued by the Home Office to the holder with an endorsement indicating that the named person is allowed to stay indefinitely in the UK or has no time limit on their stay in the UK, when produced in combination with an official document giving the person's permanent National Insurance number and their name issued by a Government agency or a previous employer.
- A full birth or adoption certificate issued in the UK which includes the name(s) of at least one of the holder's parents or adoptive parents, when produced in combination with an official document giving the person's permanent National Insurance number and their name issued by a Government agency or a previous employer.
- A birth or adoption certificate issued in the Channel Islands, the Isle of Man or Isle and when produced in combination with an official document giving the person's permanent National Insurance number and their name issued by a Government agency or a previous employer.

- A certificate of registration or naturalisation as a British citizen, when produced in combination with an official document giving the person's permanent National Insurance number and their name issued by a Government agency or a previous employer.
- A current passport endorsed to show that the holder is allowed to stay in the UK and is currently allowed to work and is not subject to a condition preventing the holder from doing work relating to the carrying on of a licensable activity.
- A current Biometric Immigration Document (Biometric Residence Permit) issued by the Home Office to the holder which indicates that the named person can currently stay in the UK and is allowed to work relating to the carrying on of a licensable activity.
- A current Residence Card issued by the Home Office to a person who is not a national of a European Economic Area state or Switzerland but who is a family member of such a national or who has derivative rights of residence.
- A current Immigration Status Document containing a photograph issued by the Home Office to the holder with an endorsement indicating that the named person may stay in the UK, and is allowed to work and is not subject to a condition preventing the holder from doing work relating to the carrying on of a licensable activity when produced in combination with an official document giving the person's permanent National Insurance number and their name issued by a Government agency or a previous employer.
- A Certificate of Application, less than 6 months old, issued by the Home Office under regulation 17(3) or 16A (2) of the Immigration (European Economic Area) Regulations 2006, to a person who is not a national of a European Economic Area state or Switzerland but who is a family member of such a national or who has derivative rights of residence.
- Reasonable evidence that the person has an outstanding application to vary their permission to be in the UK with the Home Office such as the Home Office acknowledgement letter or proof of postage evidence, or reasonable evidence that the person has an appeal or administrative review pending on an Immigration decision, such as an appeal or administrative review reference number.
- Reasonable evidence that a person who is not a national of a European Economic Area state or Switzerland but who is a family member of such a national or who has derivative rights of residence in exercising treaty rights in the UK including:-
 - evidence of the applicant's own identity – such as a passport;
 - evidence of their relationship with the European Economic Area family member – e.g. a marriage certificate, civil partnership certificate or birth certificate; and
 - evidence that the European Economic Area national has a right of permanent residence in the UK or is one of the following if they have been in the UK for more than 5 months:
 - (i) working e.g. employment contract, wage slips, letter from the employer;
 - (ii) self-employed e.g. contracts, invoices, or audited accounts with a bank;
 - (iii) studying e.g. letter from the school, college or university and evidence of sufficient funds; or
 - (iv) self-sufficient e.g. bank statements.

Family members of European Economic Area nationals who are studying or financially independent must also provide evidence that the European Economic Area national and any family members hold comprehensive sickness insurance in the UK. This can include a private medical insurance policy, an EHIC card or an S1, S2 or S3 form.

Original documents must not be sent to licensing authorities. If the document copied is a passport, a copy of the following pages should be provided:-

- (i) any page containing the holder's personal details including nationality;
- (ii) any page containing the holder's photograph;
- (iii) any page containing the holder's signature;
- (iv) any page containing the date of expiry; and
- (v) any page containing information indicating the holder has permission to enter or remain in the UK and is permitted to work.

If the document is not a passport, a copy of the whole document should be provided.

Your right to work will be checked as part of your licensing application and this could involve us checking your immigration status with the Home Office. We may otherwise share information with the Home Office. Your licence application will not be determined until you have complied with this guidance.

Privacy Notice – Licensing Act 2003

How we will use your information

The information provided to us will be used to help us process your application.

Your personal data is processed under a contract to which you are party to through your application for a licence (as per Article 6(1)(b) of the General Data Protection Regulation). In terms of special category data including criminal records, your information is processed as it is necessary for the performance of a task carried out in the public interest (as per Article 9(2)(g) of the General Data Protection Regulation).

Your application will be processed in line with the following pieces of legislation:

- Licensing Act 2003

Who we will share your information with

We may share your information with the following third parties in order to inform decision making:

- Responsible Authorities
 - South Yorkshire Police
 - South Yorkshire Fire and Rescue
 - Public Health
 - Safeguarding Children
 - Environmental Protection
 - Health Protection
 - British Waterways Board / Navigation Authority
 - Home Office
 - Trading Standards
- Other Licensing Authorities relevant to your application
- Other Council Services
- Bodies Responsible for auditing or administering public funds

How long we will keep your information

The information you provide will be kept for the duration of your licence, plus six years, after which time it will be deleted.

The information will be stored either in paper form and/or electronically on a secure council database.

What are your rights

You have rights under Data Protection law. For further details about your rights, the contact details of our Data Protection Officer and your rights to make a complaint please see our Data Protection web page:

<https://www.sheffield.gov.uk/privacy>

If you do not have access to the internet, please contact us and we will be able to provide paper versions of the information you require.

I have read and understood the information provided in this form and understand my personal information will be used in the processing of my application and/or request.

Name: JAMES O'HARA

Signature: 

Date: 11/11/20

Plan ;

07:48



×

Lease, Abbeydale Picture Hou...

PDF - 5.1 MB

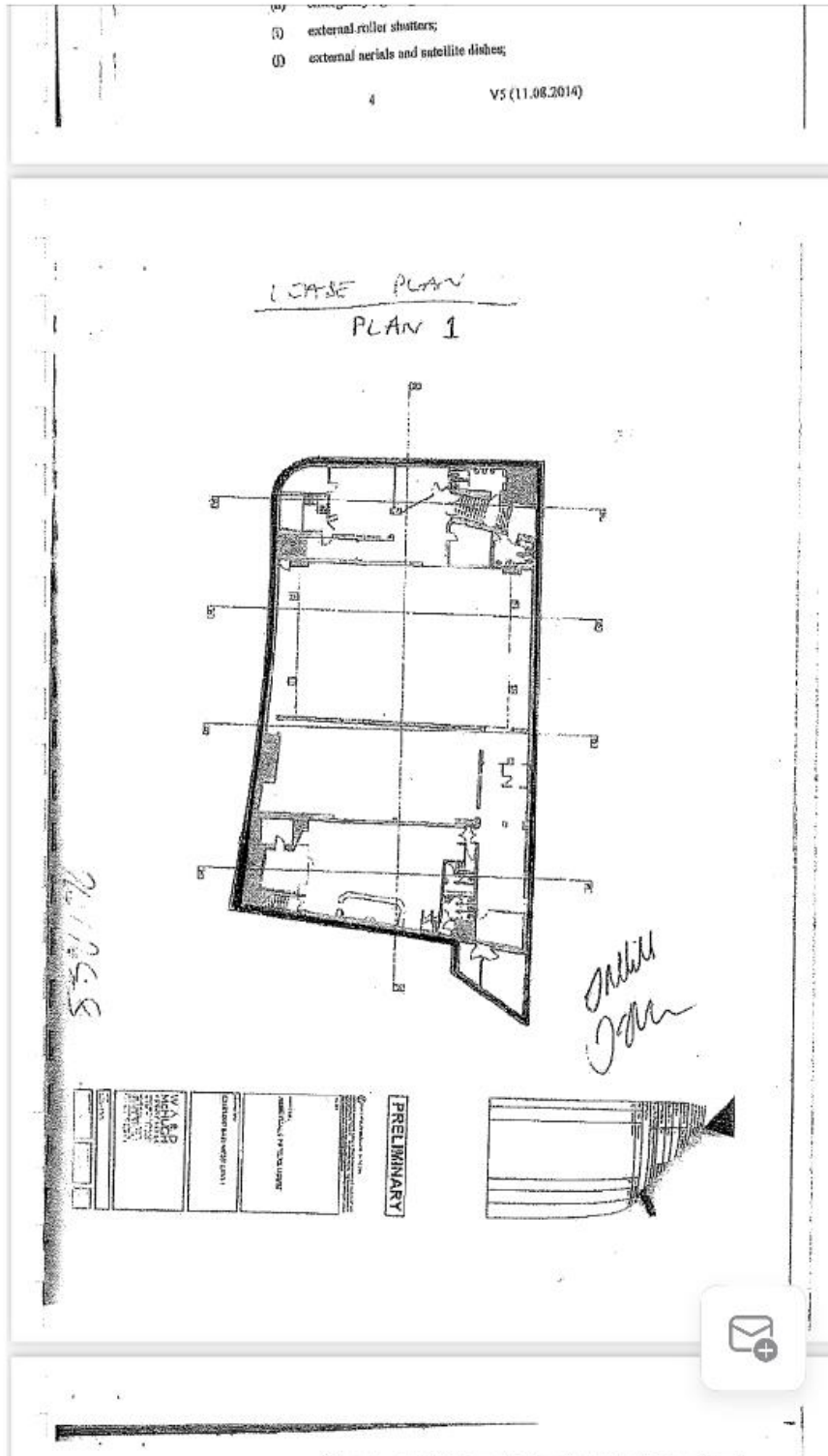

Appendix 'B'

Objection: Correspondence (mediation);

OBJ -1

Received via email, 7th Dec 2020

I have looked at and have been thinking about the application for a licence to serve drinks and food at the Abbeydale Picture House (Picture House Social, 383 Abbeydale Road, Sheffield, S7 1FS)

Allowing this opening until 00.30 on week days and until 3am at weekends etc. will substantially change the nature of this part of Sheffield. If allowed, this permission will not only have an immediate effect on the locality, with noise, parking, vehicle movements being engendered. It will also give the green light for other drinking establishments to apply for similar late night opening licences and to make this into a late bar environment.

A high proportion of the local population are families with young children. Many of them are from Asian backgrounds who don't want their kids to grow up in an area that is based on the sort of culture that this environment would bring.

I know that the white middle class people who live on or around Ecclesall Road have been largely successful in warding off attempts to have late night opening in their area. Please don't allow this to be a means of exporting that noise and social problems to the poorer communities on and around Abbeydale Road.

Regards

Marion Gerson

Licensing Emails, Applicants responses.

Good morning Ms Gerson

Thank you for your emailed objection against the Picture House Social premises application which I acknowledge.

The file has now been passed to me to see if we can resolve the issues you have raised in your email with the applicant so we can hopefully avoid attending a Licensing Sub-Committee hearing; a Licensing Sub-Committee hearing is legally required if we are unable to resolve any outstanding objections against an application within a specific timescale.

I have informed the applicant of the content of your objection (personal information redacted) so they are aware.

To help assist in resolving the issues, are you in a position to confirm what hours you would be happy with so the applicant can consider this and propose any changes.

Thank you for your time, and please do not hesitate to contact me if you have any queries.

Kind regards

Shimla

Mrs Shimla Finch

Licensing Strategy & Policy Officer

Licensing Service, Business Strategy & Regulation, Block C, Staniforth Road Depot, Sheffield, S9 3HD

Email to applicant:

Good morning

I'm writing in regards to your application made for the above premises under the Licensing Act 2003.

Your file has been passed to me as we are now at the end of the consultation period and we have unfortunately received a resident objection against your application and I am hoping we can resolve the issues raised so we can avoid it going to a Licensing Sub-Committee hearing for determination.

I have copied the content of the objection and redacted any personal information as below; I will contact the objector directly to see what hours they would deem appropriate and I will contact you back, please let me know in the meantime if there are any proposals on your side you are happy to make to resolve the issues raised–

“I have looked at and have been thinking about the application for a licence to serve drinks and food at the Abbeydale Picture House (Picture House Social, 383 Abbeydale Road, Sheffield, S7 1FS)

Allowing this opening until 00.30 on week days and until 3am at weekends etc. will substantially change the nature of this part of Sheffield. If allowed, this permission will not only have an immediate effect on the locality, with noise, parking, vehicle movements being engendered. It will also give the green light for other drinking establishments to apply for similar late night opening licences and to make this into a late bar environment.

A high proportion of the local population are families with young children. Many of them are from Asian backgrounds who don't want their kids to grow up in an area that is based on the sort of culture that this environment would bring.

I know that the white middle class people who live on or around Ecclesall Road have been largely successful in warding off attempts to have late night opening in their area. Please don't allow this to be a means of exporting that noise and social problems to the poorer communities on and around Abbeydale Road.”

Please do not hesitate to contact me if you have any queries or questions.

Kind regards

Shimla

Mrs Shimla Finch

Licensing Strategy & Policy Officer

Licensing Service, Business Strategy & Regulation, Block C, Staniforth Road Depot, Sheffield, S9 3HD

Response from Applicant:

Hi Shimla,

Thanks for getting in touch and forwarding on the objection,

In terms of the opening part around noise, parking and the like i would refer to the planning departments decision to allow us to change the planning permission that has then allowed us to apply for this alteration to the license. They took in to account the nature of the building, which is underground and has no windows or doors from the bar directly on to the street and also acknowledged that as we have been tenant of this site for nearly 7 years and never received a single complaint from residents about noise, or otherwise they took the decision to grant us the new permissions.

I'd also say that in terms of 'giving the green light' to other establishments we very much doubt that the planning department would take this decision lightly on other premises that are of the more traditional variety in terms of structure and aren't underground and off street like ourselves. Further to this we actually are not alone in having later operating hours - Hagglers Corner is very close by and has a license that allows for even later than what we are asking for.

The second part of the email where the complainant talks speculatively about what people from various cultural backgrounds may or may not want or what people from other cultural backgrounds in other parts of the city may or may not have done is best left alone, it's not something we would like to comment on given it's not based on any available facts, is completely unquantifiable and shows a willingness to presume what other people want.

What i would say is that the vast majority of our customers are local residents and they've been asking us for a later license for years and as a business in the current climate we're determined, if given the permission, to use it responsibly and with great care for the community we've been a big part of for the last 7 years.

This sort of care and consideration is mirrored in our other businesses, i doubt you'd find a complaint from the public across all our bars and cafes (Ambulo, Public, The Great Gatsby) and we fully intend to keep up this unblemished record.

Hope that helps.

Jim

(This email was forwarded to the objector on 14th December 2020) No response was received prior to the writing of this report)

Appendix 'C'

Hearing Regulations, Notices, Procedure



Notice of hearing of representations in respect of the following application: LA03 Premises Licence Application

James O'Hara
Bar Public Limited

Sent via email

The Sheffield City Council being the licensing authority, 11th November 2020 on the, received an application in respect of the premises known as;

Picture House Social 383 Abbeydale Road Sheffield S7 1FS

During the consultation period, the Council received a representation from the following authority / interested party:

- **1 X Interested Party**

on the likely effect of this application on the promotion of the licensing objectives, should it be granted.

The Council now **GIVES YOU NOTICE** that the representation will be considered at a hearing to be held **remotely via Zoom, on Tuesday 5th January 2021 at 2pm** ; following which the Council will issue a notice of determination of the application.

The documents which accompany this notice are the relevant representations which have been made, as defined in Section 35(5) of the Act.

The particular points on which the Council considers that it will want clarification at the hearing from a party are as follows:

- 1) Your response to the representation made, upon which you may ask and be asked questions by the parties to the hearing.
- 2) You may also be asked questions by the parties to the hearing, relating to your application for a licence.

Please complete the attached form LAR1 and return it to: **Licensing Service, Sheffield City Council, Block C Staniforth Road Depot, Staniforth Road, Sheffield, S9 3HD** within five (5) working days before the day or the first day on which the hearing is to be held.

Dated: 17th December 2020

Signed: **C Stephenson**
The officer appointed for this purpose
Licensing Strategy and Policy Officer

Please address any communications to: Licensing Service, Sheffield City Council, Block C Staniforth Road Depot Staniforth Road Sheffield S9 3HD. licensing@sheffield.gov.uk



**Notice of hearing of representations
in respect of the following application:
LA03 Premises Licence Application**

Marion Gerson

Sent via email:

The Sheffield City Council being the licensing authority, on the 11th November 2020 received an application in respect of the premises known as;

Picture House Social 383 Abbeydale Road Sheffield S7 1FS

During the consultation period, the Council received a representation from the following authority / interested party:

- **1 x Interested party**

on the likely effect of this application on the promotion of the licensing objectives, should it be granted.

The Council now **GIVES YOU NOTICE** that the representation will be considered at a hearing to be held **remotely via Zoom, on Tuesday 5th January 2021**; following which the Council will issue a notice of determination of the application.

The documents which accompany this notice are the relevant representations which have been made, as defined in Section 35(5) of the Act.

The particular points on which the Council considers that it will want clarification at the hearing from a party are as follows:

- 3) The representation you have made with reference to these particular premises and the four core objectives.
- 4) You may also be asked questions by the parties to the hearing, relating to your representations.

Please complete the attached form LAR1 and return it to: **Licensing Service, Sheffield City Council, Block C Staniforth Road Depot, Staniforth Road, Sheffield, S9 3HD** within five (5) working days before the day or the first day on which the hearing is to be held.

Dated: 17th December 2020

Signed: **Clive Stephenson**
The officer appointed for this purpose
Licensing Strategy and Policy Officer

Please address any communications to: Licensing Service, Sheffield City Council, Block C Staniforth Road Depot Staniforth Road Sheffield S9 3HD. licensing@sheffield.gov.uk **NOTES**

Right of attendance, assistance and representation

15. Subject to regulations 14(2) and 25, a party may attend the hearing and may be assisted or represented by any person whether or not that person is legally qualified.

Representations and supporting information

16. At the hearing a party shall be entitled to –
- (a) in response to a point upon which the authority has given notice to a party that it will want clarification under regulation 7(1)(d), give further information in support of their application, representations or notice (as applicable),
 - (b) if given permission by the authority, question any other party; and
 - (c) address the authority

Failure of parties to attend the hearing

20. – (1) If a party has informed the authority that he does not intend to attend or be represented at a hearing, the hearing may proceed in his absence.
- (2) If a party who has not so indicated fails to attend or be represented at a hearing the authority may:–
- (a) where it considers it to be necessary in the public interest, adjourn the hearing to a specified date, or
 - (b) hold the hearing in the party's absence.
- (3) Where the authority holds the hearing in the absence of a party, the authority shall consider at the hearing the application, representations or notice made by that party.
- (4) Where the authority adjourns the hearing to a specified date it must forthwith notify the parties of the date, time and place to which the hearing has been adjourned.

Procedure at hearing

21. Subject to the provisions of the Regulations, the authority shall determine the procedure to be followed at the hearing.
22. At the beginning of the hearing, the authority shall explain to the parties the procedure which it proposes to follow at the hearing and shall consider any request made by a party under regulation 8(2) for permission for another person to appear at the hearing, such permission shall not be unreasonably withheld.
23. A hearing shall take the form of a discussion led by the authority and cross-examination shall not be permitted unless the authority considers that cross-examination is required for it to consider the representations, application or notice as the case may require.
24. The authority must allow the parties an equal maximum period of time in which to exercise their rights provided for at regulation 16.
25. The authority may require any person attending the hearing who in their opinion is behaving in a disruptive manner to leave the hearing and may –
- (a) refuse to permit that person to return, or
 - (b) permit him to return only on such conditions as the authority may specify,
- but such a person may, before the end of the hearing, submit to the authority in writing any information which they would have been entitled to give orally had they not been required to leave.

Regulation 8

- (1) A party shall give to the authority within the period of time provided for in the following provisions of this regulation a notice stating –
 - (a) whether he intends to attend or be represented at the hearing;
 - (b) whether he considers a hearing to be unnecessary
- (2) In a case where a party wishes any other person (other than the person he intends to represent him at the hearing) to appear at the hearing, the notice referred to in paragraph (1) shall contain a request for permission for such other person to appear at the hearing accompanied by details of the name of that person and a brief description of the point or points on which that person may be able to assist the authority in relation to the application, representations or notice of the party making the request.

- (3) In the case of a hearing under –

- (a) section 48(3)(a) (cancellation of interim authority notice following police objection), or
- (b) section 105(2)(a) (counter notice following police objection to temporary event notice),

the party shall give the notice no later than one working day before the day or the first day on which the hearing is to be held.

- (4) In the case of a hearing under –

- (a) section 167(5)(a) (review of premises licence following closure order),
- (b) paragraph 4(3)(a) of Schedule 8 (determination of application for conversion of existing licence), paragraph 16(3)(a) of Schedule 8 (determination of application for conversion of existing club certificate)
- (c) paragraph 26(3)(a) of Schedule 8 (determination of application by holder of justices' licence for grant of personal licence),

the party shall give the notice no later than two working days before the day or the first day on which the hearing is to be held.

- (5) In any other case, the party shall give the notice no later than five working days before the day or the first day on which the hearing is to be held.

Licensing Act 2003 – Hearing Procedure – Regulation 7 (1)

This procedure has been drawn up in accordance with the Licensing Act 2003 to assist those parties attending Licensing Committee hearings.

1. The hearing before the Council is Quasi Judicial.
 2. The Chair of the Licensing Committee will introduce the Committee and ask officers to introduce themselves.
 3. The Chair will ask the applicants to formally introduce themselves.
 4. The Solicitor to the Committee will outline the procedure to be followed at the hearing.
 5. Hearing Procedure:-
 - (a) The Licensing Officer will introduce the report.
 - (b) Questions concerning the report can be asked both by Members and the applicant.
 - (c) The Licensing Officer will introduce in turn representatives for the Responsible Authority and Interested Parties who will be asked to detail their relevant representations.
 - (d) Members may ask questions of those parties
 - (e) With the leave of the Chair the applicant or his representative may cross examine the representatives of the Responsible Authorities and Interested Parties.
 - (f) The applicant/licensee (or his/her nominated representative) will then be asked to:-
 - (i) detail the application;
 - (ii) provide clarification on the application and respond to the representations made.
 - (g) The applicant/licensee (or his/her nominated representative) may then be asked questions by members and with the leave of the Chair from the other parties present.
 - (h) The applicant will then be given the opportunity to sum up the application.
 - (i) The Licensing Officer will then detail the options.
 - (j) There will then be a private session for members to take legal advice and consider the application.
 6. The decision of the Licensing Committee will be given in accordance with the requirements of the Licensing Act 2003 and regulations made there under.
- NB:
- 1) At any time in the Licensing Process Members of the Committee may request legal advice from the Solicitor to the Committee. This advice may be given in open session or in private.
 - 2) The Committee Hearing will be held in public unless and in accordance with the Regulations the Committee determine that the public should be excluded.

This page is intentionally left blank